

# BALL VALVES WITH LEVER HANDLE

## BV80 Series



- ✓ Self Compensating Valve Stem Seal Design Ensures Long, Leak-Tight Maintenance Free Service
- ✓ Full Thread Length Compliance with ANSI B1.20.1 Specification Allows More Flexibility in L1 (hand) and L3 (wrench) Pipe Makeup for Handle Orientation and or Positive Sealing with Lesser Quality Mating Pipe Threads
- ✓ Machined Reinforced PTFE Seats and Stem Seal Standard for Uniform Operating Torque and Long Life
- ✓ Bar Stock Construction Offers Optimum Material Strength and Consistency

The BV80 Series is a standard port, two-piece body offered in 1/4 thru 2" pipe size. Proper valve selection is dependent on your flow and functional requirements as well as physical size and value considerations.

The BV80 Series, all internal components, including the polymer seats, are precisely machined to strict tolerances, assuring repeated bubble tight sealing and maximum valve life. Our spring loaded stem seal provides automatic compensation for stem seal wear and thermal expansion and contraction. Each valve is bubble tested to ensure reliable, leak tight performance.

The BV80 Series are ideal for automation when coupled to our compact pneumatic or electric actuators.

The BVP80, BVPS80, and BVPE80 series are ball valves coupled to actuators.



BV81-SS shown smaller than actual size.

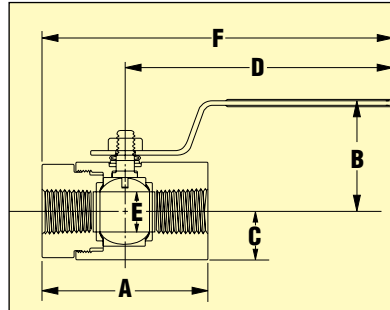

Valve Size	Dimensions - inches					
	A	B	C	D	E	F
1/4 & 3/8	2.22	1.75	0.50	4.0	0.36	5.09
1/2	2.61	1.84	0.59	4.0	0.49	5.30
3/4	2.94	2.00	0.75	5.38	0.62	6.85
1	3.32	2.28	1.00	5.38	0.80	7.04
1 1/4	3.70	2.93	1.06	6.75	0.97	8.60
1 1/2	4.25	3.19	1.31	6.75	1.25	8.87
2	4.57	3.37	1.50	6.75	1.50	9.41

### SPECIFICATIONS

**Materials of Construction Body:**

**Brass:** ASTM B-16

**316SS:** ASTM A276

**Ball and Stem:** 316 SS

**Seats and Stem Seal:** Glass Reinforced PTFE

**Temperature:** -45 to 232°C (-50 to 450°F) (see Pressure Temperature Chart)

**Pressure:** 49.6 bar (720 psi C.W.P.) [Cold Working Pressure to 65.5°C (150°F)] (see Pressure Temperature Chart)

**Vacuum:** 20 Micron

**Saturated Steam:** 10.3 bar (150 psi)

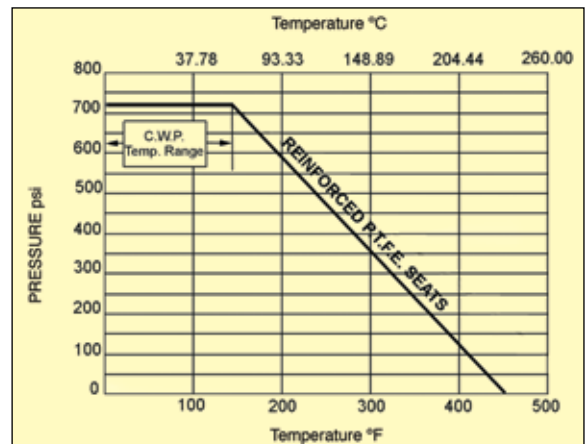

**To Order Visit [omega.com/bv80](http://omega.com/bv80) for Pricing and Details**

Brass	316 Stainless Steel	FNPT Size
Model No.	Model No.	
BV81	BV81-SS	1/4
BV82	BV82-SS	3/8
BV83	BV83-SS	1/2
BV84	BV84-SS	3/4
BV85	BV85-SS	1
BV86	BV86-SS	1 1/4
BV87	BV87-SS	1 1/2
BV88	BV88-SS	2

Comes complete with operator's manual.

**Ordering Examples:** BV81, 1/4 FNPT ball valve.

BV85-SS, 1 FNPT 316SS ball valve