

ASPHERIC COEFFICIENTS

	R	K	A4	A6	A8	A10
S1	8.09	-0.6789586	2.3949836E-05	-	-	-
S2	-	-	-	-	-	-

$$z = \frac{Y^2}{R(1 + \sqrt{1 - (1+k)Y^2/R^2})} + A_2Y^2 + A_4Y^4 + A_6Y^6 + A_8Y^8 + A_{10}Y^{10}$$

ASPHERIC LENS EQUATION

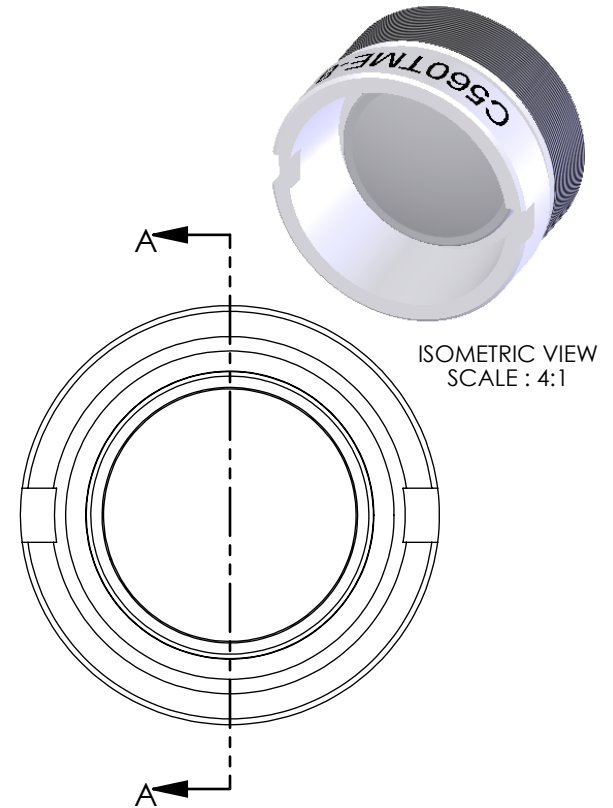
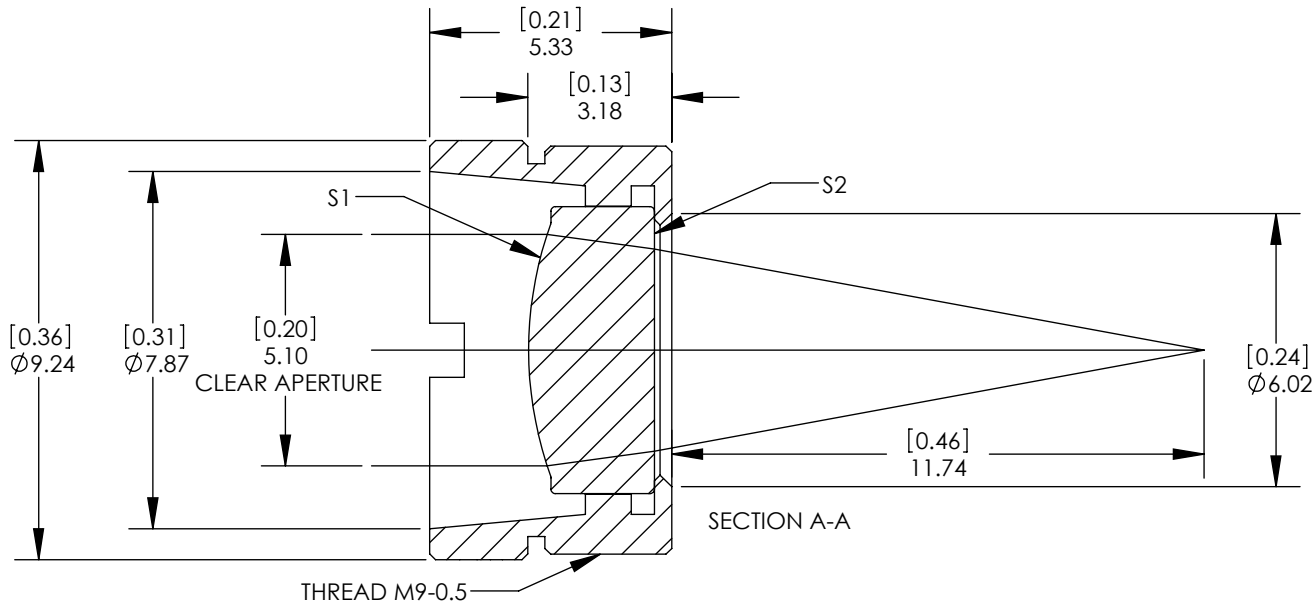

NOTES/SPECIFICATIONS:

- DESIGN WAVELENGTH: 650nm
- EFFECTIVE FOCAL LENGTH: 13.86mm
- EFL TOLERANCE: ±1%
- NUMERICAL APERTURE: 0.18
- WORKING DISTANCE (LENS): 12.11mm
- WORKING DISTANCE (MOUNT): 11.74mm
- DIAMETER TOLERANCE: ±0.15mm
- CENTER THICKNESS TOLERANCE: ±0.04mm
- SURFACE QUALITY: 40-20 SCRATCH-DIG (INCLUDES ENTIRE BULK MATERIAL)
- RMS WFE (AXIAL @ 632.8nm): <DIFFRACTION LIMIT
- MAGNIFICATION: INFINITE
- REFRACTIVE INDEX (AT DESIGN WAVELENGTH) 1.584
- INDEX TOLERANCE: ±0.002
- COATING(S1&S2): BBAR Ravg: <0.5% FROM 600-1050nm

DIMENSIONS ARE IN [in]
mm

	NAME	DATE
DRAWN	GG	10/09/09
ENG APPR.	SG	04/09/10
MFG APPR.	PM	04/09/10

PROPRIETARY AND CONFIDENTIAL
THE INFORMATION CONTAINED IN THIS DRAWING IS THE SOLE PROPERTY OF THORLABS, INC. ANY REPRODUCTION IN PART OR AS A WHOLE WITHOUT THE WRITTEN PERMISSION OF THORLABS, INC. IS PROHIBITED.

THORLABS INC. PO BOX 366
NEWTON NJ

TITLE: B-COATED MOUNTED ASPHERIC LENS
EFL=13.86mm

MATERIAL: D-ZK3 SIZE A REV. B

SCALE: 6:1 SHEET 1 OF 1

DWG. NO. 20372-E01 PART NO. C560TME-B