

10113947 - X0C - X0XL F										
<div>6-COLUMN DIFFERENTIAL SIGNAL</div> <div>LEAD-FREE DESIGNATION ONLY WITH APPLICABLE PLATING CODES</div>										
MODULE DESCRIPTION	LETTER DESIGNATION REPRESENTED IN DASH NUMBER									BASE MODULE
LEFT POLARIZING GUIDANCE MODULE (SEE SHEET 3)	J	A	B	C	D	E	F	G	H	
RIGHT POLARIZING GUIDANCE MODULE (SEE SHEET 4)	Y	P	Q	R	S	T	U	V	W	
OPEN MODULE (TWO WALL) (SEE SHEET 2)	0 (ZERO)									
LEFT WALL MODULE (SEE SHEET 5)	L									
RIGHT WALL MODULE (SEE SHEET 6)	M									
FOUR WALL MODULE (SEE SHEET 7)	1									

OPEN (2-WALL) MODULE

SEE NOTE 8

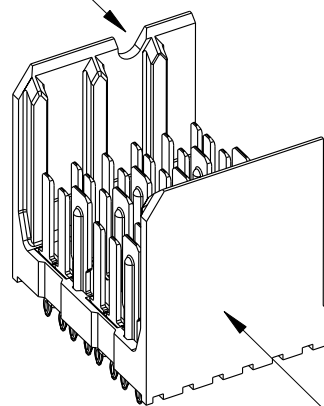

SEE NOTE 5

POSN A1

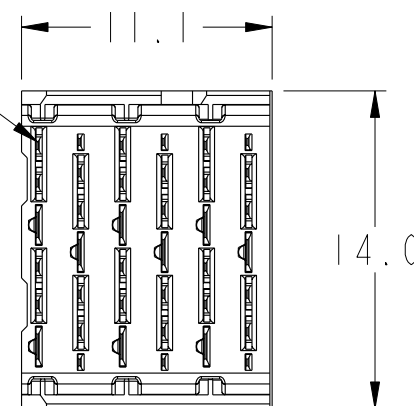

SCALE 3:1

6.2 (4mm WIPE WIDE GROUNDS)
5.2 (3mm WIPE WIDE GROUNDS)

5.2 (THIN END GROUNDS)
5.2 (3mm WIPE SIGNALS)
4.2 (2mm WIPE SIGNALS)

(SEE P/N TREE FOR
ALL COMBINATIONS AVAILABLE)

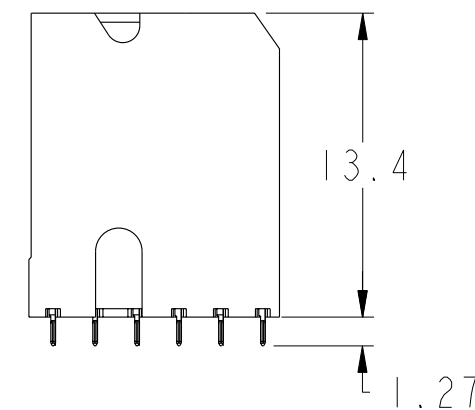
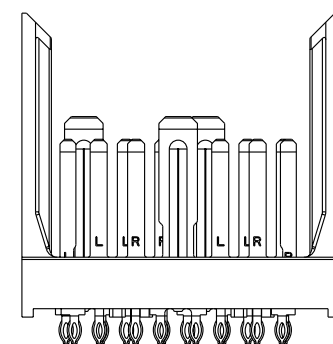
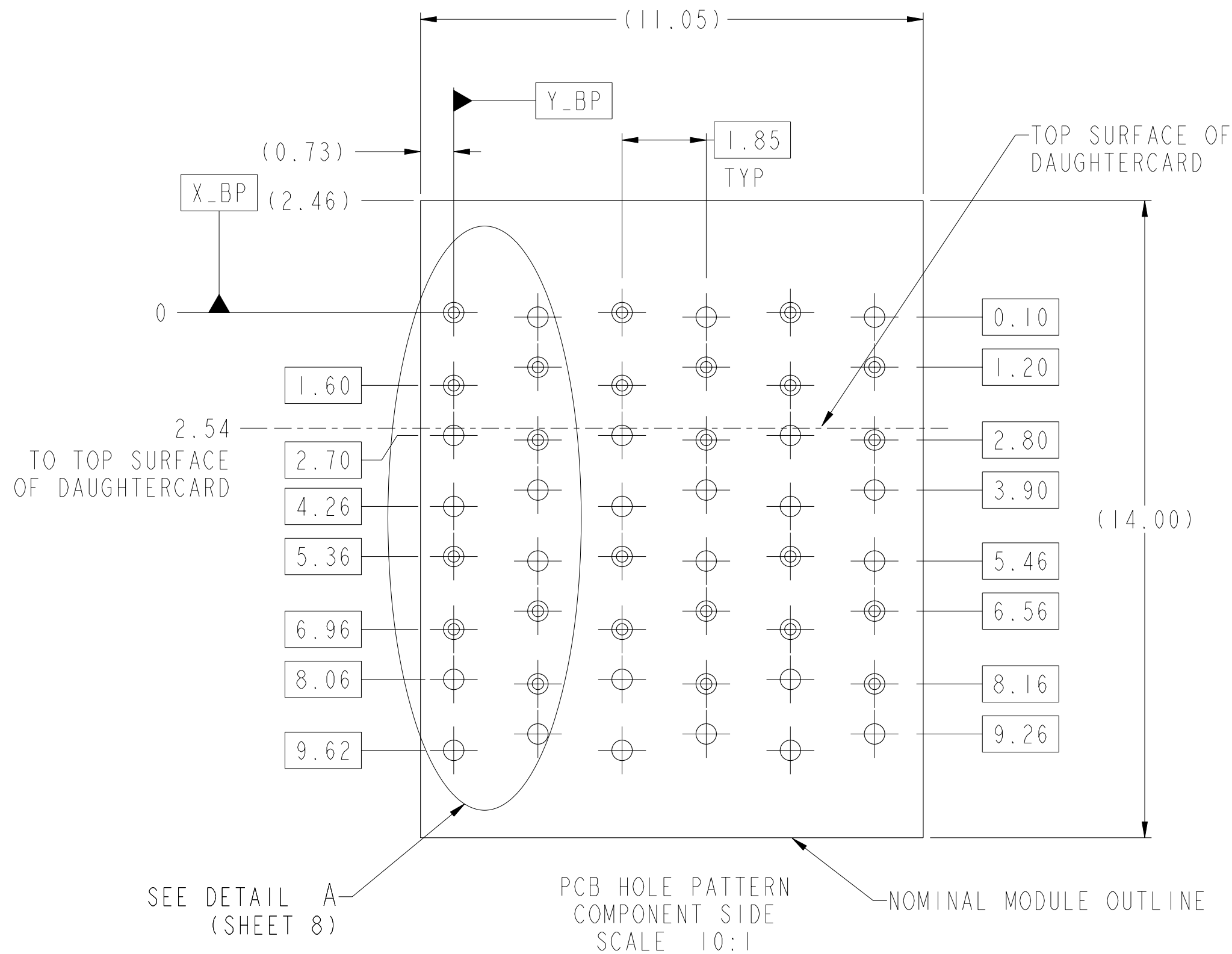
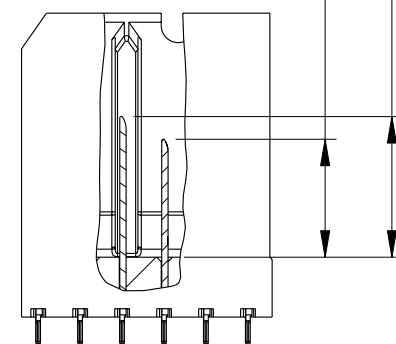

PRELIMINARY



MODULE ASSEMBLY
VERTICAL HEADER, 6-COLUMN, 2-PAIR
SEE P/N TREE

10113947
CUSTOMER
sheet 2 of 8

PDM: Rev:1 STATUS: In Work 8 Printed: Aug 06, 2010

LEFT POLARIZING/GUIDE MODULE

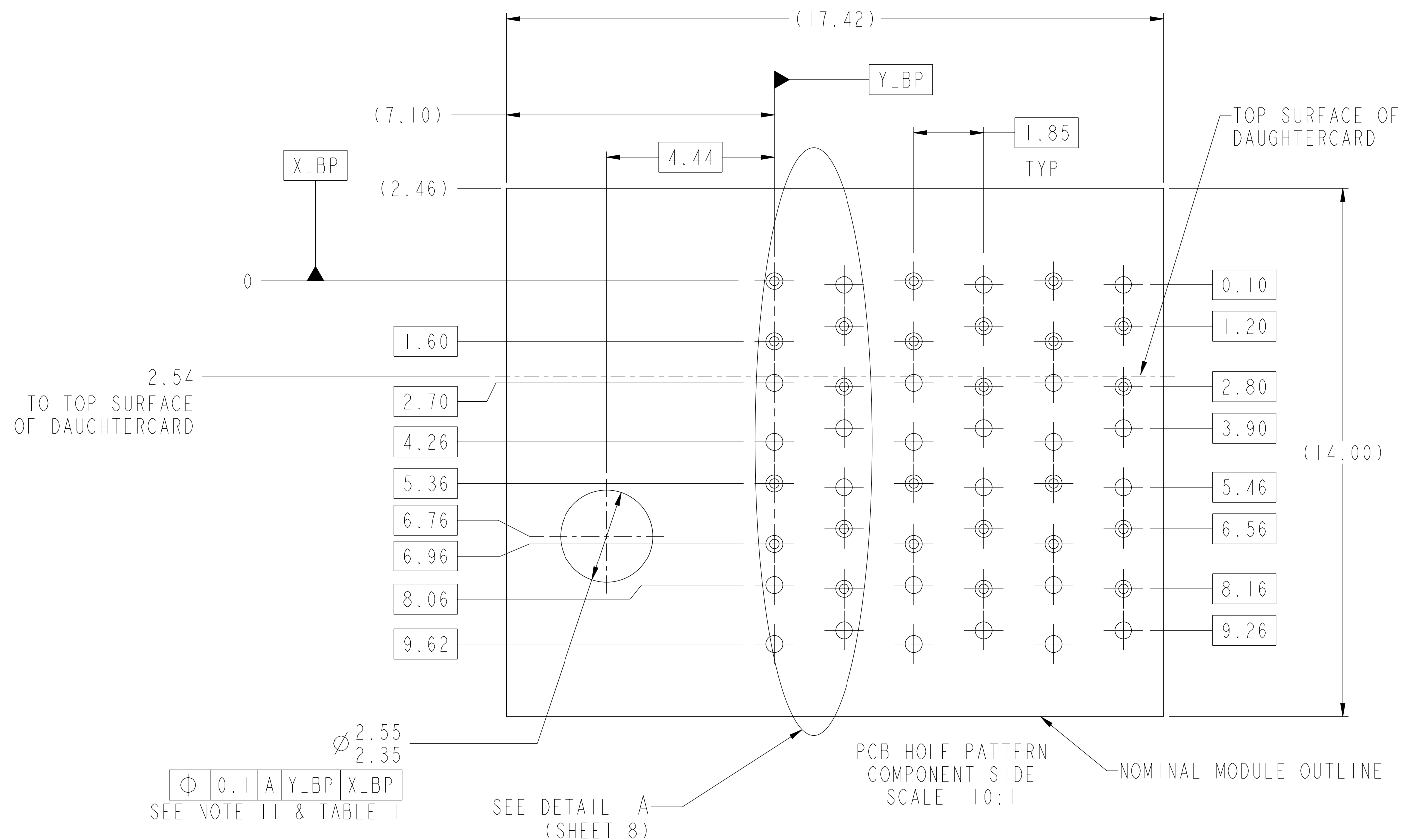
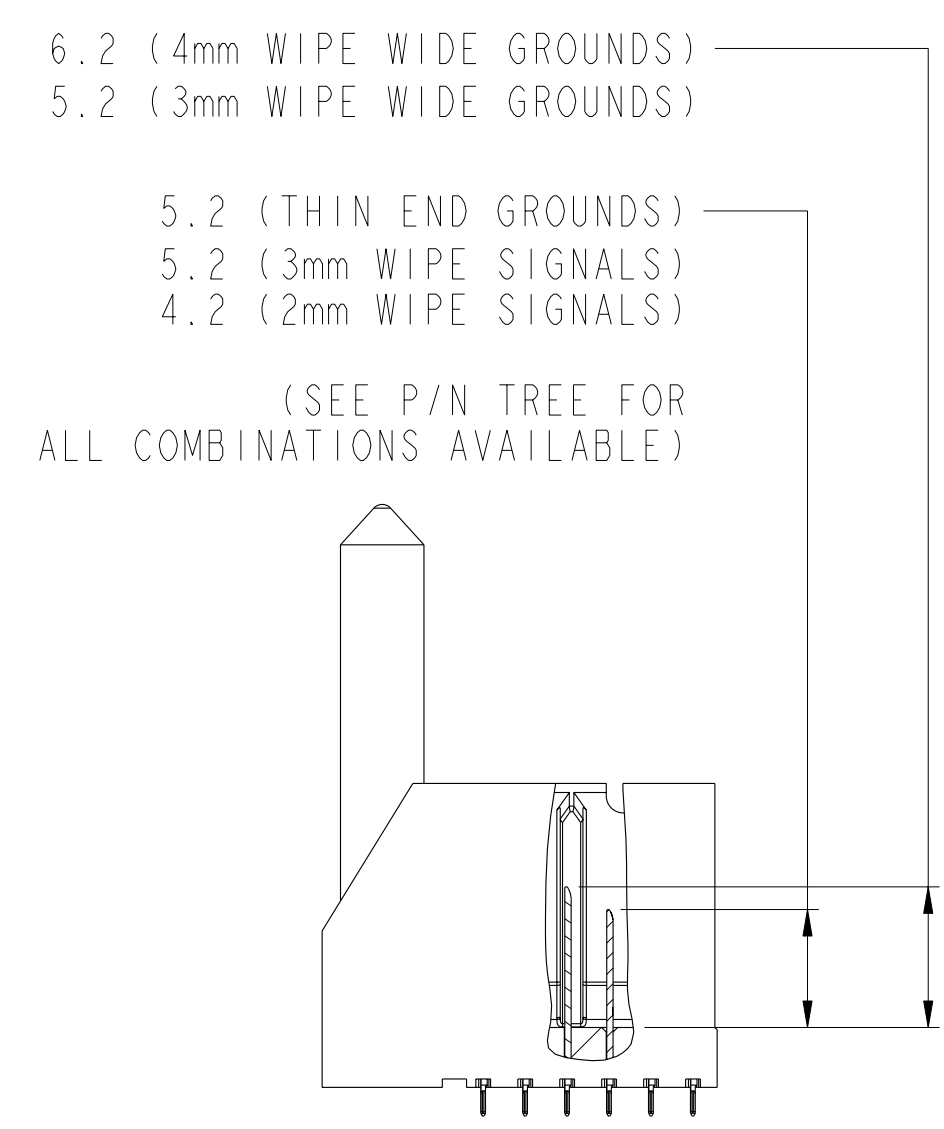
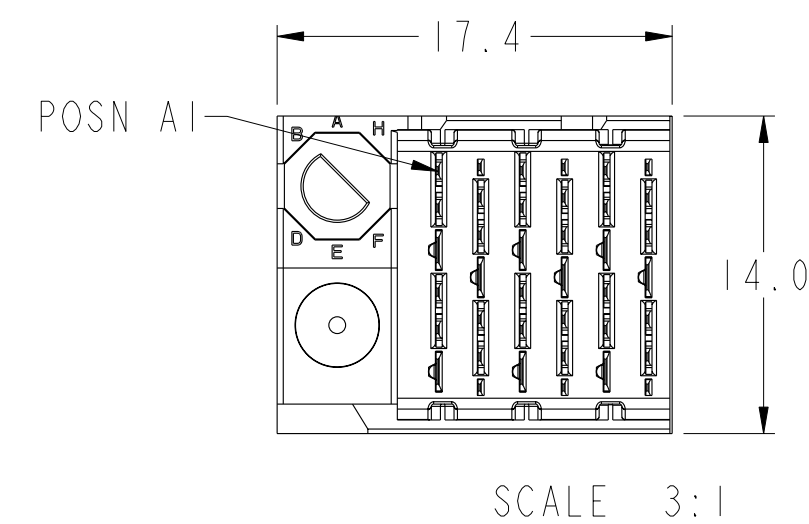
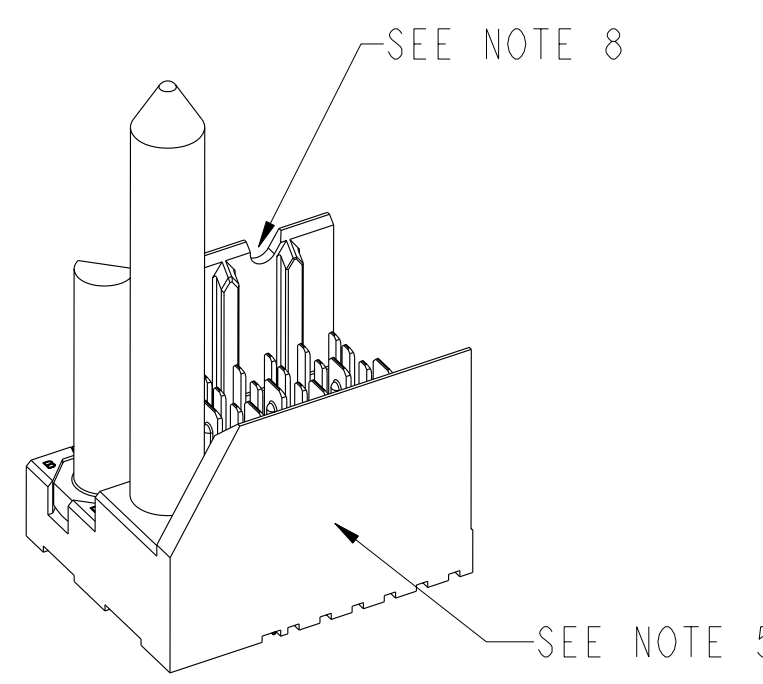

⌀	0.1	A	Y_BP	X_BP
---	-----	---	------	------

SEE NOTE 11 & TABLE 1

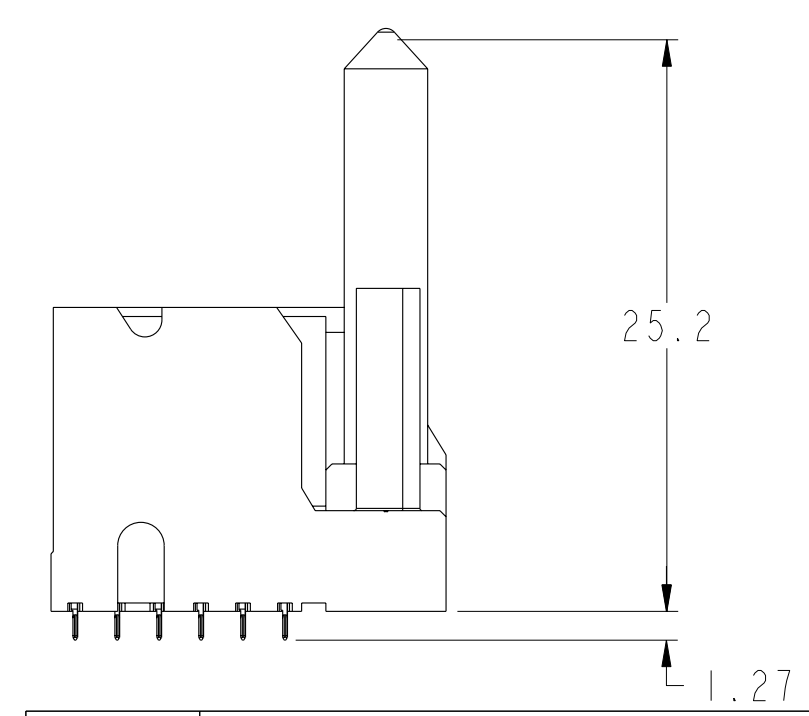
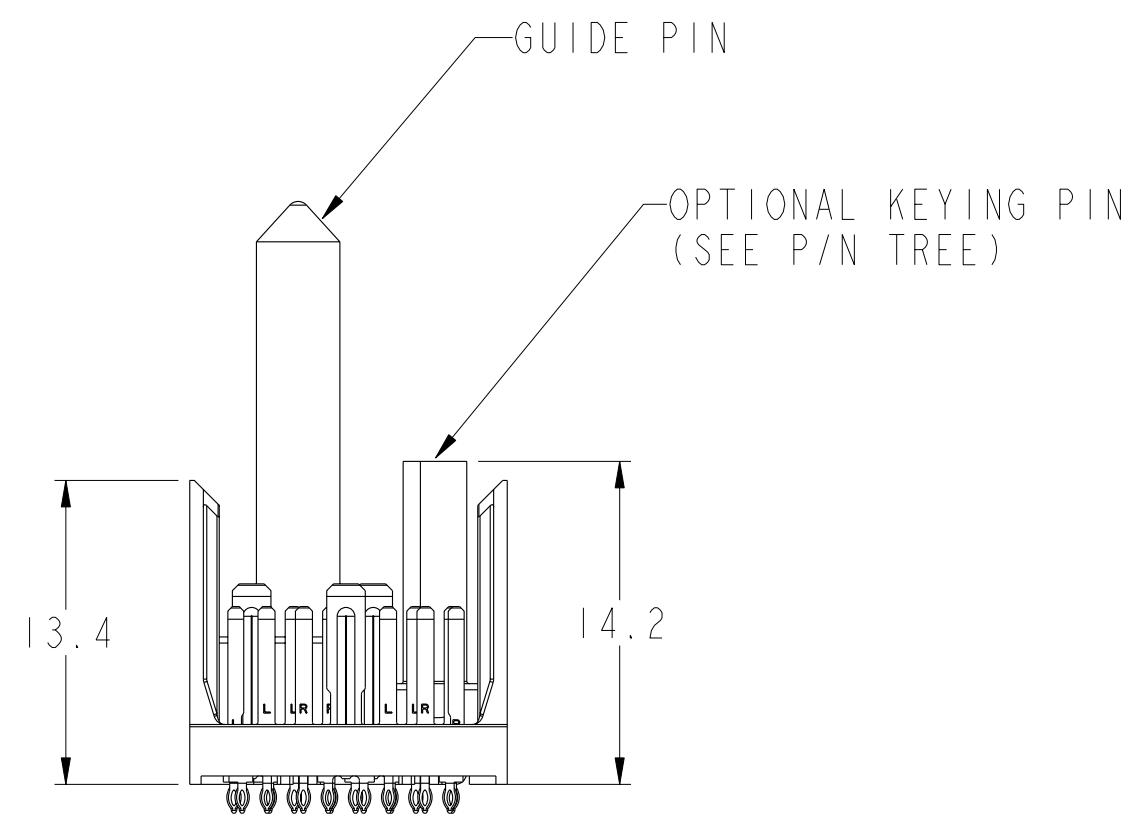

PRELIMINARY

	title	MODULE ASSEMBLY	dwg no	10113947	Rev.	I
		VERTICAL HEADER, 6-COLUMN, 2-PAIR				
	catalog no	SEE P/N TREE	CUSTOMER	sheet 3 of 8		

RIGHT POLARIZING/GUIDE MODULE

SEE NOTE 8

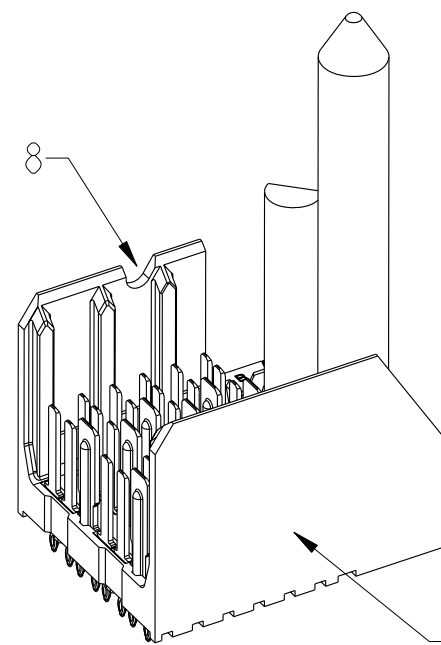

SEE NOTE 5

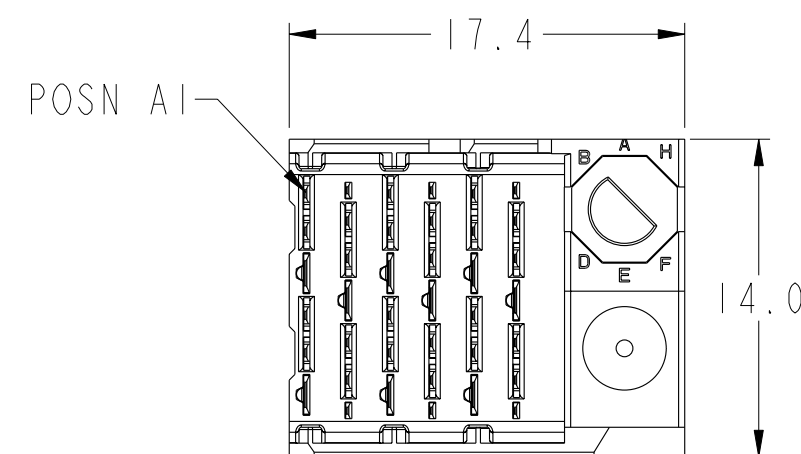

SCALE 3:1

6.2 (4mm WIPE WIDE GROUNDS)
5.2 (3mm WIPE WIDE GROUNDS)

5.2 (THIN END GROUNDS)
5.2 (3mm WIPE SIGNALS)
4.2 (2mm WIPE SIGNALS)

(SEE P/N TREE FOR
ALL COMBINATIONS AVAILABLE)

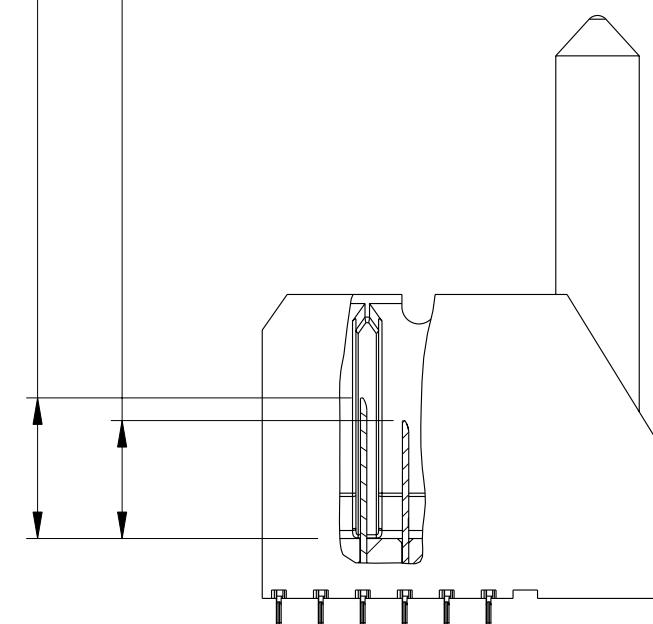

2.54
TO TOP SURFACE
OF DAUGHTERCARD

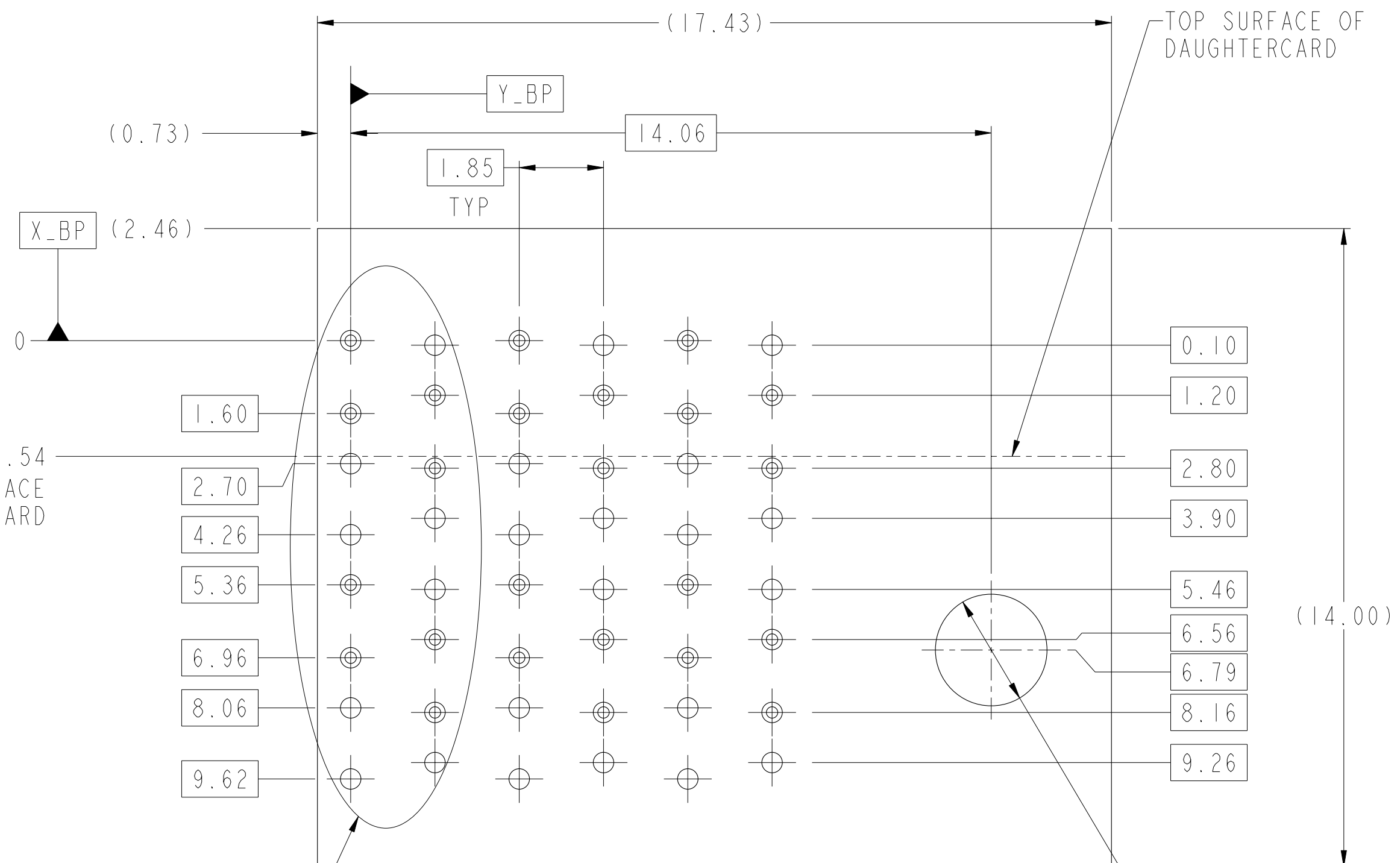

SEE DETAIL A
(SHEET 8)

NOMINAL MODULE OUTLINE

PCB HOLE PATTERN
COMPONENT SIDE
SCALE 10:1

Ø 2.55
2.35

Ø 0.10 A Y_BP X_BP
SEE NOTE 11 & TABLE 1

GUIDE PIN

OPTIONAL KEYING PIN
(SEE P/N TREE)

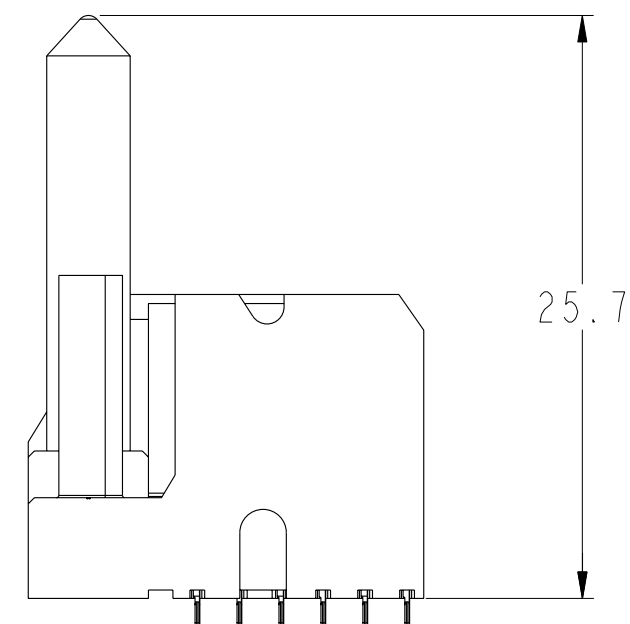
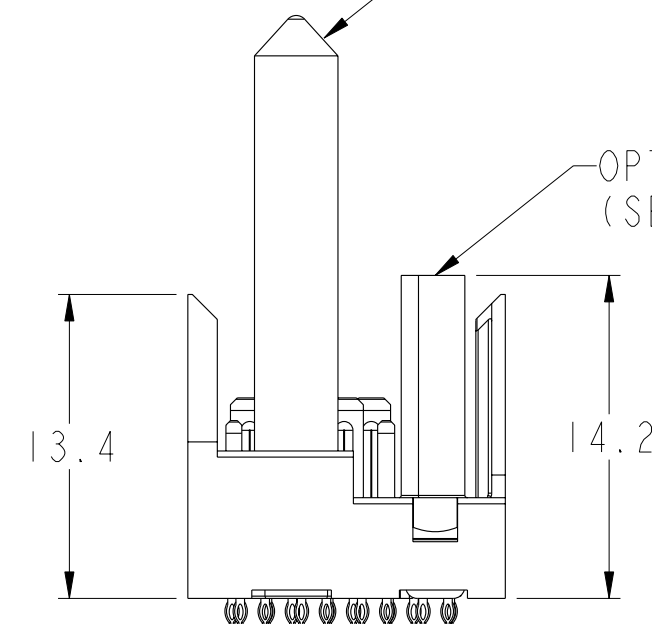

1.27

PRELIMINARY



title MODULE ASSEMBLY
VERTICAL HEADER, 6-COLUMN, 2-PAIR
catalog no SEE P/N TREE

dwg no 10113947
Rev. 1
CUSTOMER sheet 4 of 8

PDM: Rev:1 STATUS: In Work 8 Printed: Aug 06, 2010

LEFT WALL MODULE

SEE NOTE 8

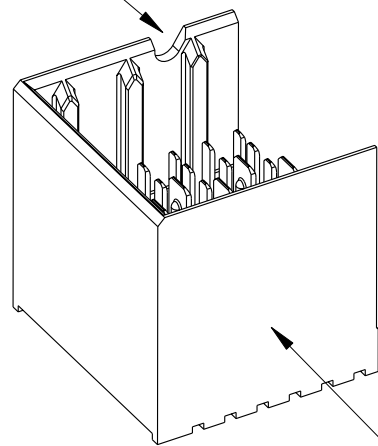

SEE NOTE 5

POSN A1

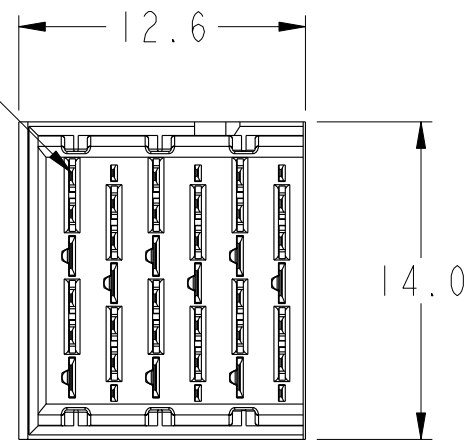

SCALE 3:1

6.2 (4mm WIPE WIDE GROUNDS)
5.2 (3mm WIPE WIDE GROUNDS)

5.2 (THIN END GROUNDS)
5.2 (3mm WIPE SIGNALS)
4.2 (2mm WIPE SIGNALS)

(SEE P/N TREE FOR
ALL COMBINATIONS AVAILABLE)

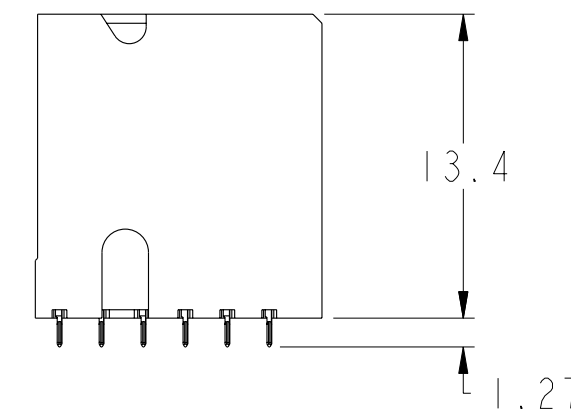
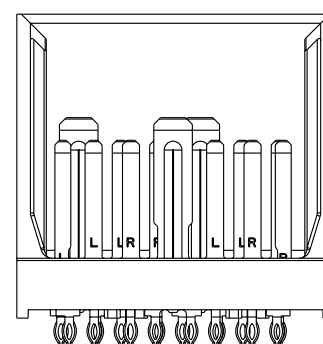
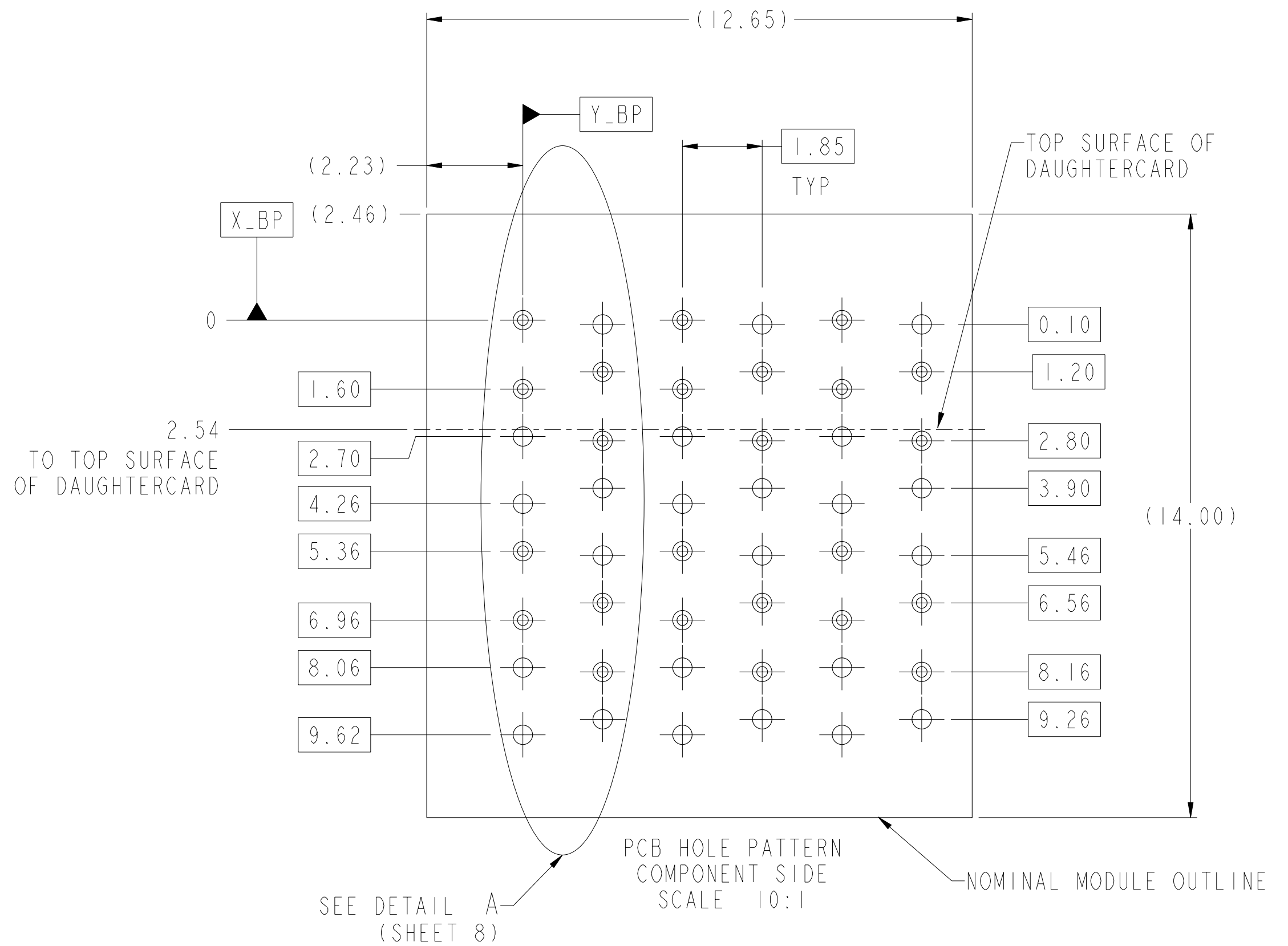
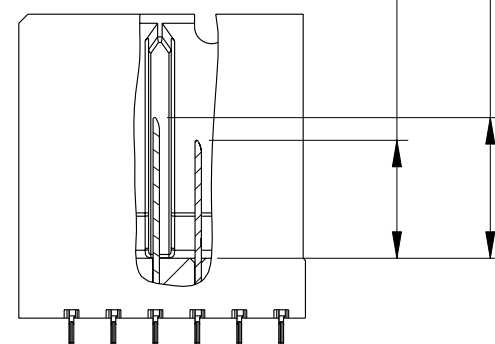

PRELIMINARY



MODULE ASSEMBLY
VERTICAL HEADER, 6-COLUMN, 2-PAIR
SEE P/N TREE

10113947
CUSTOMER
sheet 5 of 8

RIGHT WALL MODULE

SEE NOTE 8

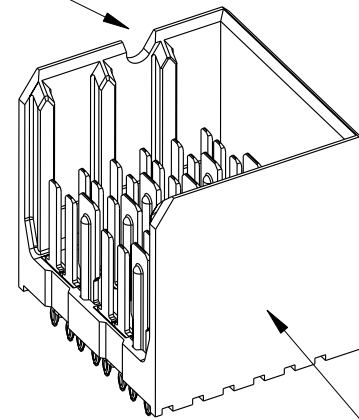

SEE NOTE 5

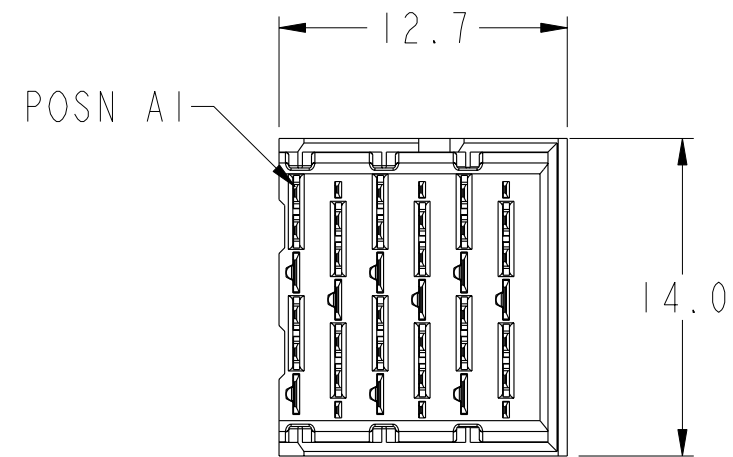

SCALE 3:1

6.2 (4mm WIPE WIDE GROUNDS)
5.2 (3mm WIPE WIDE GROUNDS)

5.2 (THIN END GROUNDS)
5.2 (3mm WIPE SIGNALS)
4.2 (2mm WIPE SIGNALS)

(SEE P/N TREE FOR
ALL COMBINATIONS AVAILABLE)

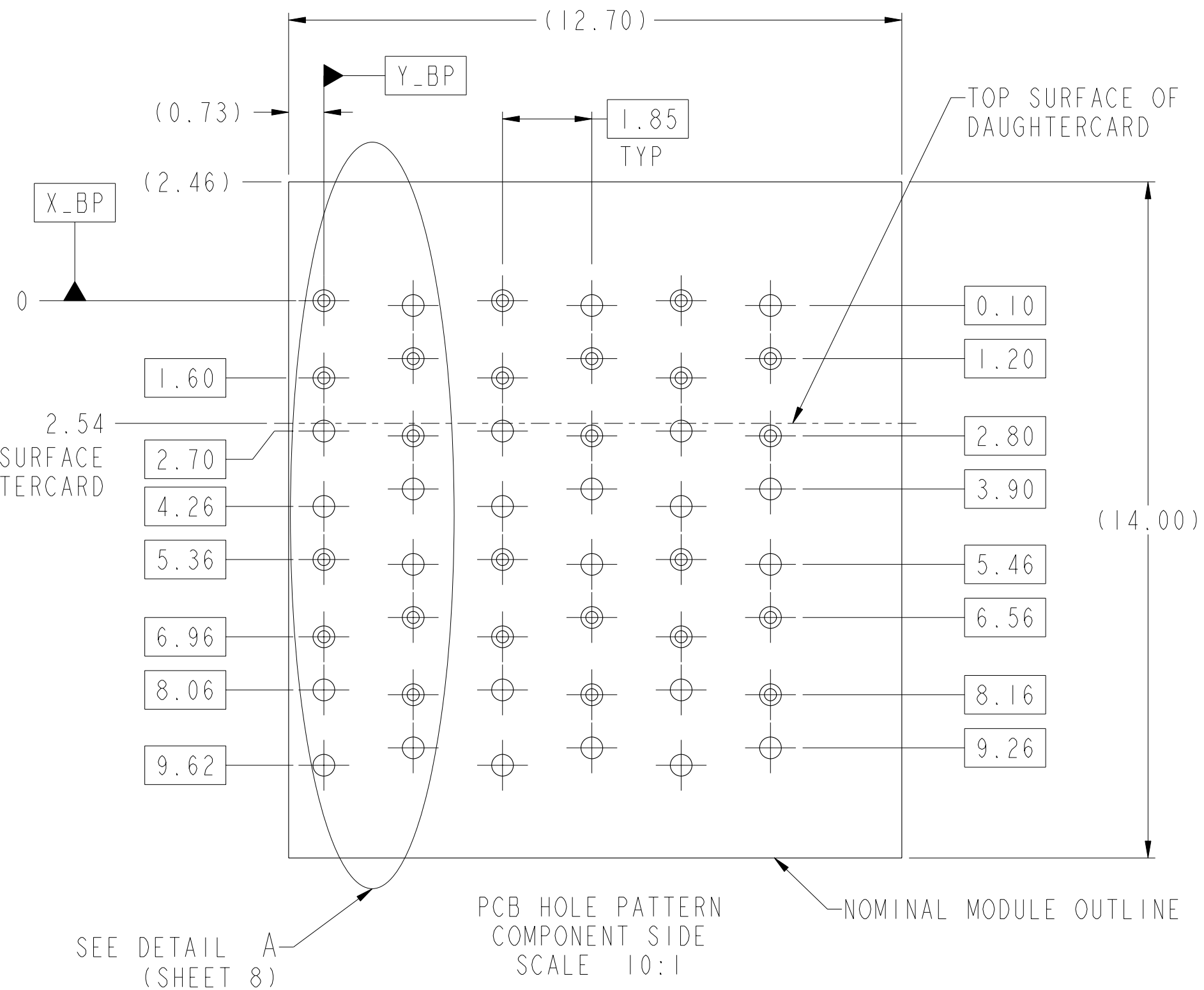
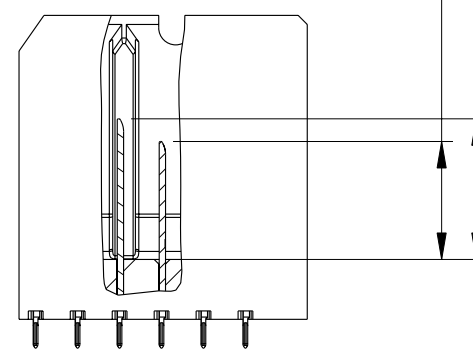

SEE DETAIL A
(SHEET 8)

PCB HOLE PATTERN
COMPONENT SIDE
SCALE 10:1

NOMINAL MODULE OUTLINE

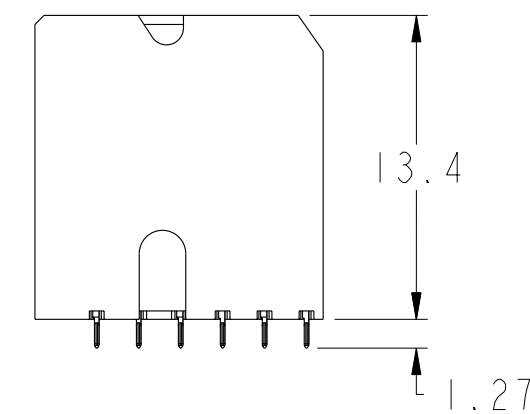
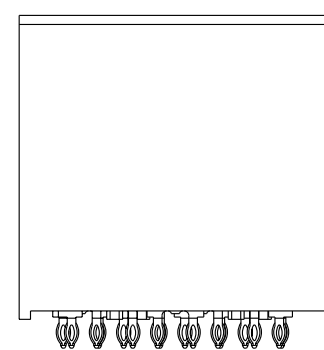

PRELIMINARY



title MODULE ASSEMBLY
VERTICAL HEADER, 6-COLUMN, 2-PAIR
catalog no SEE P/N TREE

dwg no 10113947
Rev. 1
CUSTOMER sheet 6 of 8

FOUR WALL MODULE

SEE NOTE 8

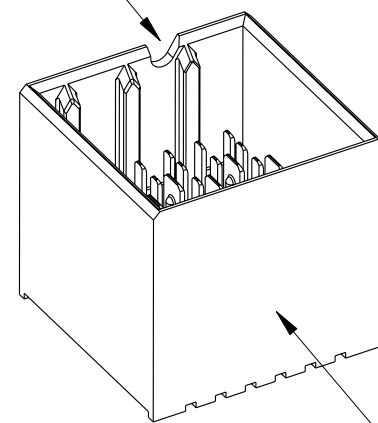

SEE NOTE 5

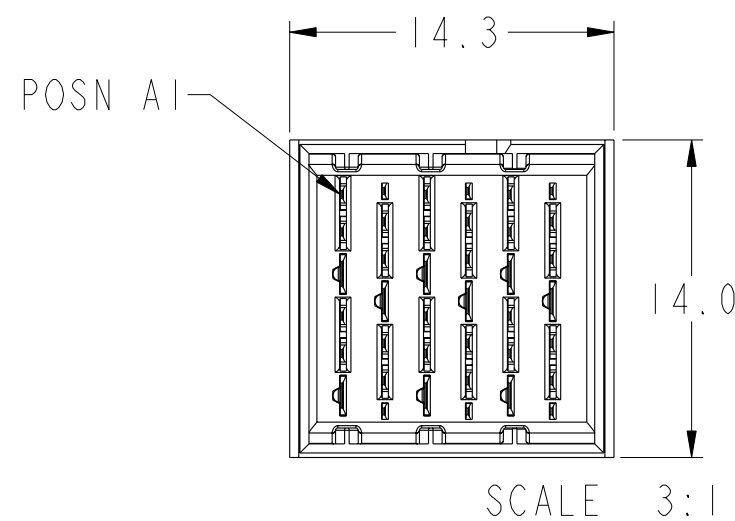

6.2 (4mm WIPE WIDE GROUNDS)
5.2 (3mm WIPE WIDE GROUNDS)

5.2 (THIN END GROUNDS)
5.2 (3mm WIPE SIGNALS)
4.2 (2mm WIPE SIGNALS)

(SEE P/N TREE FOR
ALL COMBINATIONS AVAILABLE)

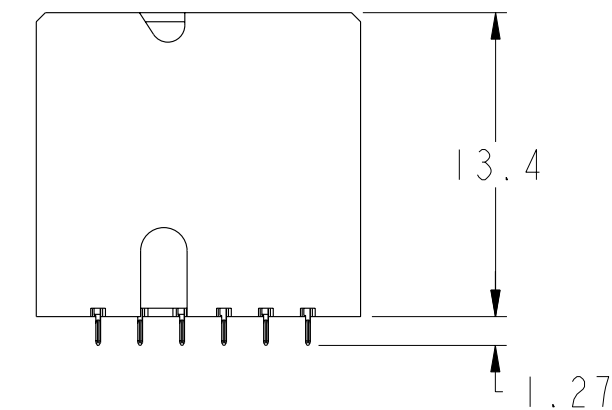
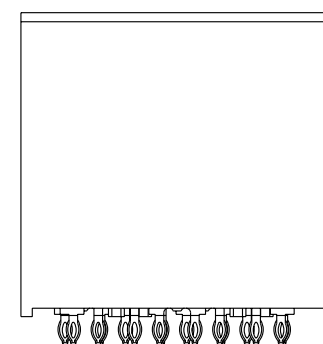
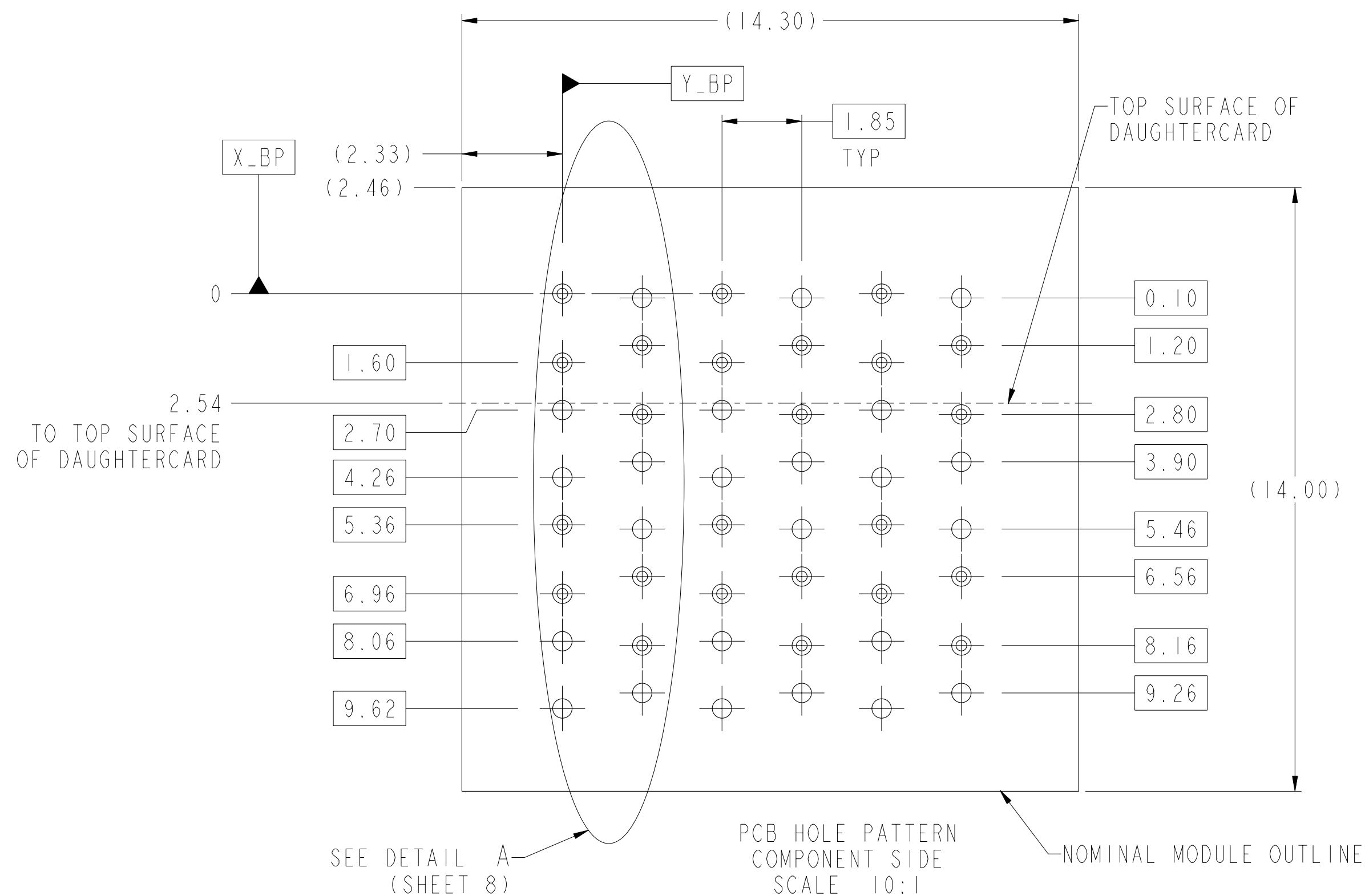
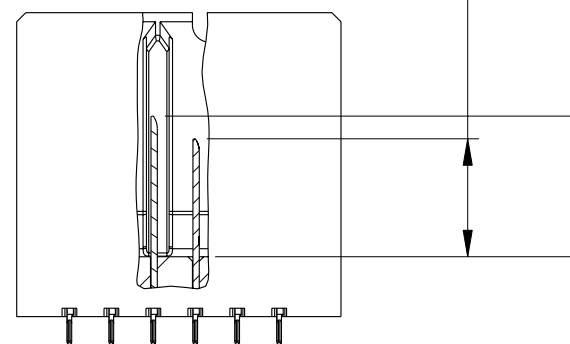

PRELIMINARY



MODULE ASSEMBLY
VERTICAL HEADER, 6-COLUMN, 2-PAIR
SEE P/N TREE

10113947
CUSTOMER
sheet 7 of 8

PDM: Rev:1 STATUS: In Work 8 Printed: Aug 06, 2010

NOTES:

- CONNECTOR MATERIALS
SHROUD: HIGH-TEMP THERMOPLASTIC, UL94V-0
CONTACTS: HIGH PERFORMANCE COPPER ALLOY
- CONTACT PLATING:

SEPARABLE INTERFACE: PERFORMANCE-BASED PLATING, QUALIFIED TO MEET THE REQUIREMENTS OF FCI PRODUCT SPECIFICATION GS-12-588, INCLUDING TELCORDIA GR-1217-CORE (NOVEMBER 1995) CENTRAL OFFICE TEST SEQUENCE.

PRESS-FIT TAILS: TIN OVER NICKEL, OR TIN-LEAD ALLOY OVER NICKEL. SEE P/N TREE.
- PRODUCT SPECIFICATION: GS-12-588 (PRELIMINARY)
- APPLICATION SPECIFICATION: GS-20-121 (PRELIMINARY)
- PRODUCT MARKING (PART NUMBER AND LOT CODE) ON THESE SURFACES.
- HOUSING MUST WITHSTAND EXPOSURE TO 260°C PEAK TEMPERATURE FOR 40 SECONDS IN A CONVECTION, INFRA-RED, OR VAPOR-PHASE REFLOW OVEN.
- PACKAGING MEETS GS-14-920 LEAD-FREE LABELING SPECIFICATION.
- NOTCH INDICATES "ROW A" SIDE OF CONNECTOR.
- SEE APPLICATION SPECIFICATION FOR ROUTING GUIDELINES, ADDITIONAL PTH GUIDELINES, MATED DIMENSIONS, GUIDE PN SELECTION, ETC.
- SCREW IS OPTIONAL AND ENGAGES WITH BOTTOM OF GUIDE-PIN FROM BENEATH THE PCB FOR ADDITIONAL GUIDE-PIN SUPPORT.
- OPTIONAL HOLE LOCATION FOR GROUNDED PIN OR ADDITIONAL GUIDE-PIN SUPPORT. SEE TABLE 1 ON SHEET 1 FOR ADDITIONAL DETAILS.

TABLE 3: PTH AND PAD SIZES WITH REFERENCE TO COMPLIANT PIN DRILL

COMPLIANT PIN DRILL	PTH	PAD
Ø0.55 [0.0217"]	Ø0.45±0.05	Ø0.85
Ø0.45 [0.0177"]	Ø0.35±0.05	Ø0.75

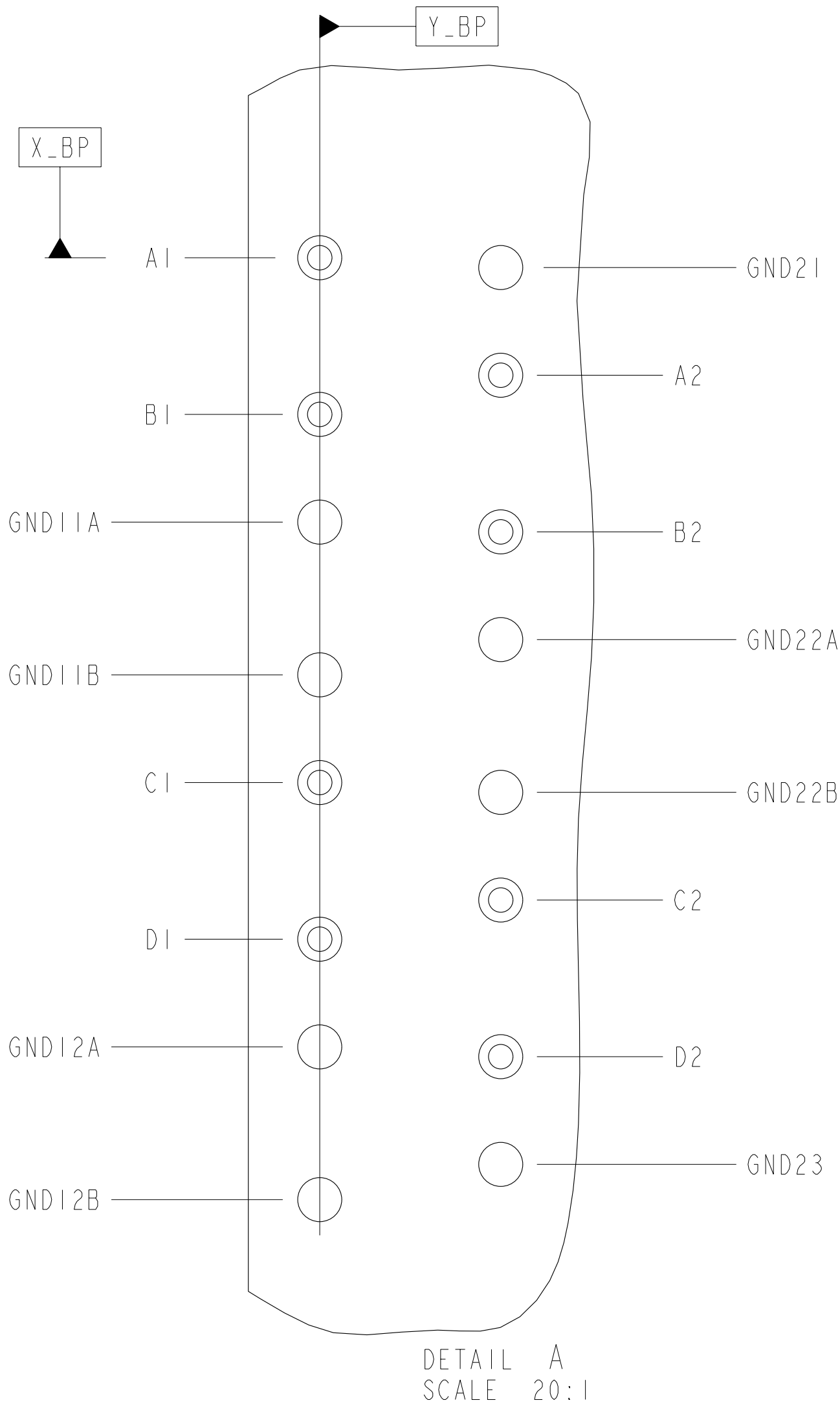

PRELIMINARY



title MODULE ASSEMBLY
VERTICAL HEADER, 6-COLUMN, 2-PAIR
catalog no SEE P/N TREE

dwg no 10113947
customer sheet 8 of 8
Rev. 1